

CASEMENT

SYSTEM

Sightlines

Frame 70 mm, Sash 70 mm

Polyamide Strip Length

32 mm

Profile Thickness

Window 1.6 mm

Glazing

Max. 44 mm, Min. 23 mm

Maximum Sash Dimensions

Slim Sash (Side Hung):

Width (L) 950 mm, Height (H) 1300 mm

Slim Sash (Top Hung):

Width (L) 1200 mm, Height (H) 1300 mm

Heavy Duty Sash (Side Hung):

Width (L) 750 mm, Height (H) 1750 mm

Heavy Duty Sash (Top Hung):

Width (L) 1800 mm, Height (H) 1800 mm

Maximum Sash Weight

Side Hung Slim Sash: 35 kg

Top Hung Slim Sash: 50 kg

Side Hung Heavy Duty Sash: 42 kg

Top Hung Heavy Duty Sash: 100 kg

Consult maximum weight and dimensions according to typologies



CASEMENT SYSTEM



Thermally broken window that allows for both side hung and top hung outward openings. This solution, with a thermal break zone of 32 mm and a transmittance U_w from 1.0 W/m^2K , has the British security certification PAS 24, being especially suitable for this market.



- High thermal & acoustic performance
- Slim sightlines
- Flush option available
- High security

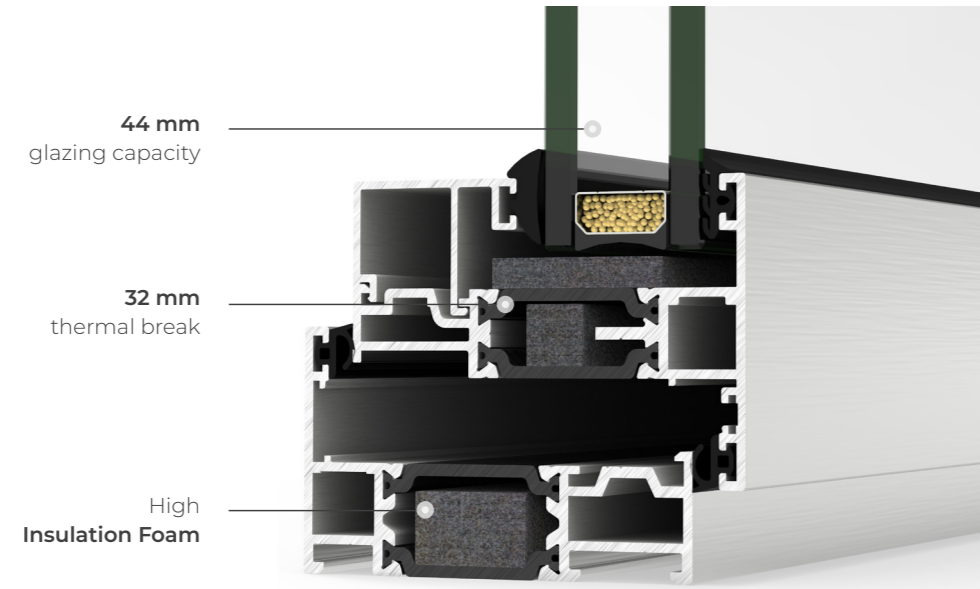

BFRC Rating
kWh/(m²·yr)

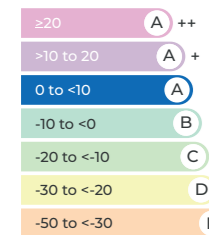

Double glazing

BFRC Rating
kWh/(m²·yr)

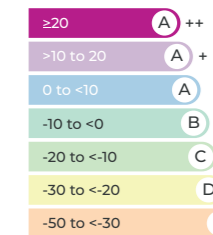

Triple glazing



FEATURES

| | | | |
|---------------------|--|---|---|
| U value | | Double glazing * U_w from 1.4 (W/m^2K) | Triple glazing * $U_w \geq 1.0$ (W/m^2K) |
| Acoustic insulation | | Rw up to 45 dB | |
| Air permeability | | Class 4 | |
| Water tightness | | Class E1200 | |
| Wind resistance | | Class CE 2400 | |
| Security test | | PAS24 ✓ Passed | |

* Double glazing $U_g=1.0$ / Triple glazing $U_g=0.5$
Security test: Reference test 1.438 x 1.33 m / 1 sash



FLUSH VERSION

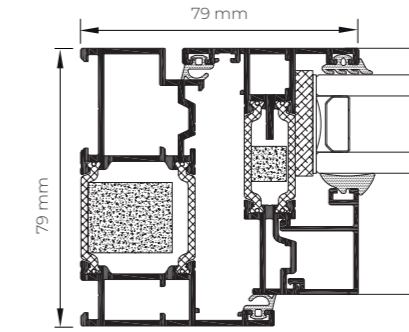

STANDARD VERSION

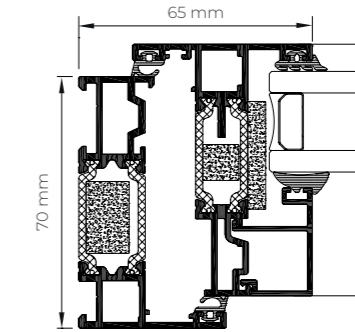

DRAINAGE SUBCILLS

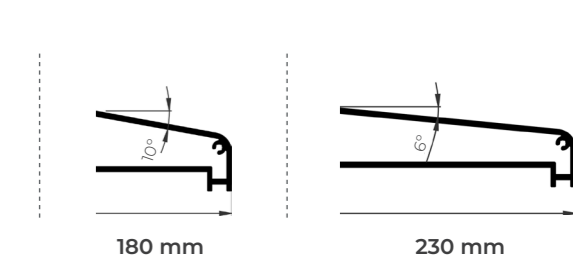
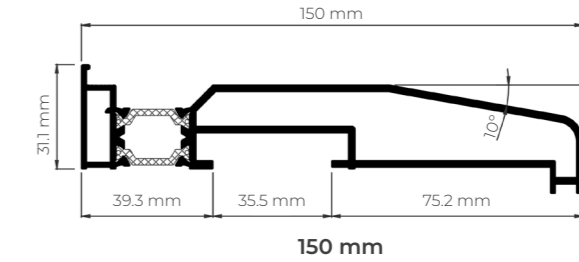
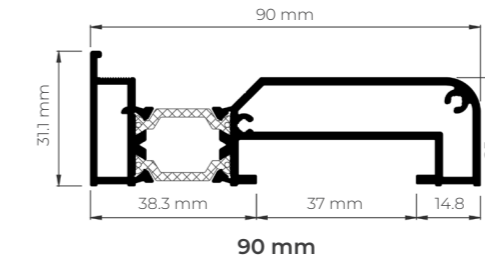

HEAD EXTENSION

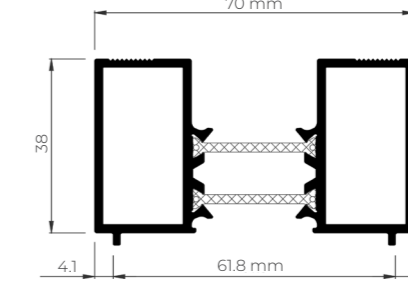
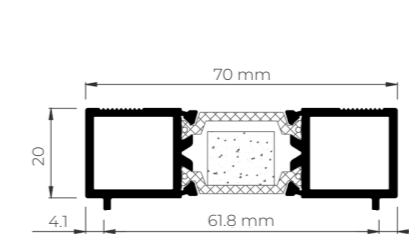

Head Extension 20 mm

Head Extension 38 mm

OPENING POSSIBILITIES

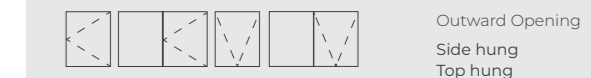

POSSIBILITIES

